

2024 NEW PRODUCTS

MINN KOTA PRODUCT OVERVIEW



WHAT IS QUEST?

QUEST Trolling Motors

Minn Kota will announce a new line extension for Ultrex, Terrova, Ulterra, and RT Instinct motors called QUEST. The new platform that will live alongside existing motors will utilize a brushless motor design and create a new technology platform for future technology development. We have taken the world's greatest trolling motors and redesigned them to outperform anything else for years to come.

PHYSICAL ATTRIBUTES

- QUEST motors are **re-engineered** from the ground up
- **Larger & stronger mount** to accommodate extra thrust and torque
- **Carbon Fiber shafts** for enhanced durability
- New propellers ensure **peak performance and power efficiency**
- New **lift-assist assembly (Ultrex)** to make getting the motor in and out of the water **effortless**

TECHNOLOGICAL ATTRIBUTES

- New motor controller and software changes have made it the **most power-efficient motor** on the market
- New **battery monitoring system** for real-time monitoring of power and **automatic power saving mode** when batteries reach 20% charge
- Motor and software designs have made QUEST the **most powerful line of trolling motors ever**
- Includes new **updated GPS system** adding features and accuracy

WHAT MAKES QUEST MOTORS DIFFERENT?

KEY POINTS OF DIFFERENTIATION

- 1. Motor Longevity:** Less contacting parts = less friction and wear = longer life
- 2. Efficiency:** Battery power is utilized more efficiently = longer run time on a single charge - up to 30%
- 3. Power:** Quest motors will be the most powerful motors series ever. Motor power is made up of multiple variants.
Thrust: Motors will have slightly more actual thrust
Torque: Considerably more torque means it will cut through weeds with ease and provide precise maneuverability even in extreme conditions. – up to 50% greater at 24V, 30% at 36V
Prop: New prop design balances better than ever weedless design with motor efficiencies.
Construction: A beefed-up motor mount, shaft, and pivot points to accommodate the increase in power.
- 4. Quiet:** These motors are taking quiet operation to a new level.
- 5. Real-time battery monitoring:** Check battery power levels while the motor is in use, real-time timer till the battery is drained, with a notification when battery power is reduced to 20%.
- 6. Programmable foot pedal:** User-programable button on the foot pedal to keep the most used feature a tap away.
- 7. Built-in MEGA Side Imaging:** Only available on Quest series motors.
- 8. No Performance Loss:** As the battery voltage drops, there will be no loss in motor performance (similar to lithium battery operation)

THE BEST MOTORS EVER MADE, MADE EVEN BETTER

THE NEW LOOK OF MINN KOTA



ULTREX

- Power steering, spot-lock and a proven track record of performance come together with added model options for the harshest environments



TERROVA/ RT TERROVA

- Terrova is known as a proven workhorse that doesn't know when to quit and a favorite for anglers



ULTERRA/ INSTINCT

- The first and only available auto stow and deploy motor in all water is now available with QUEST technology

WHAT ABOUT BRUSHED MOTORS?

NEW Reimagined Brushed Trolling Motors

ALL of the bow mount motor lines have been re-imagined from the ground up and consolidated to improve the consumer brand experience. By focusing on product line simplification we plan to streamline offering to help consumers navigate, understand and select the right product for their needs.

BRUSHED MOTOR UPDATES

- **NEW Enhanced GPS** suite to allow anglers to spend more time fishing and less time on boat control
- **Out of the Box** connection to all Humminbird units by including all necessary adapters
- **Everything is One-Boat Network Ready** – by removing i-pilot skus we remove confusion – every motor connects to Humminbird
- **Streamlined wireless remote offering** – We dedicated countless hours of research to creating the best remote experience for every angler
- **One App for Everything** – the One-Boat Network App can control everything on the boat

TROLLING MOTOR UPDATES

ENHANCED GPS INCLUDING DRIFT MODE

WHAT IS DRIFT MODE?

What problem are we solving?

Anglers continually fight environmental conditions to maintain a straight-line course heading and consistent speed.

How is Drift Mode the solution?

Drift mode will automatically engage Advanced AutoPilot and Cruise Control simultaneously to maintain boat control. Anglers will no longer need to depend on drift socks, kicker motors, or manual operation to control speed.

Can this be done today without Drift Mode?

This can be done to a point with existing features, but it requires continual manual correction of speed. This new feature will slow the boat down if your set speed is less than the wind speed, which Cruise Control cannot do today.

How can it be activated?

Drift mode can be activated from the Humminbird interface, One-Boat mobile app, and from the wireless remote (remote will ship with OBN 1 button preprogrammed set to Drift Mode)



TROLLING MOTOR UPDATES

ADAPTER CABLES

WHAT IS CHANGING?

Why do we have new adapter cables?

All motors are moving from US2 to DSC 2D sonar.

Compatibility with competitive fish finders

We will provide adapter cable options for competitive fish finders to provide generic compatibility for sonar/depth. We will not be qualifying them for full CHIRP capabilities.

Future of US2 and adapters

We will support but start to phase out US2 adapters.

• What cables will be included in box with motor

Included with Built-In MEGA DI and DSC motor models:

- (Qty 1) 490518-1 ~ CABLE, ADAPTER, TYPE 9/14 DI
- (Qty 1) 490537-2 ~ CABLE, ADAPTER, 30"-14P/7P
- (Qty 1) 720073-4 ~ CABLE, ETHERNET, 30'
- (Qty 1) 720074-1 ~ CABLE, ADAPTER, ETHERNET

Included with Built-In MEGA SI motor models:

- (Qty 1) 490537-2 ~ CABLE, ADAPTER, 30"-14P/7P
- (Qty 1) 720073-4 ~ CABLE, ETHERNET, 30'
- (Qty 1) 720074-1 ~ CABLE, ADAPTER, ETHERNET

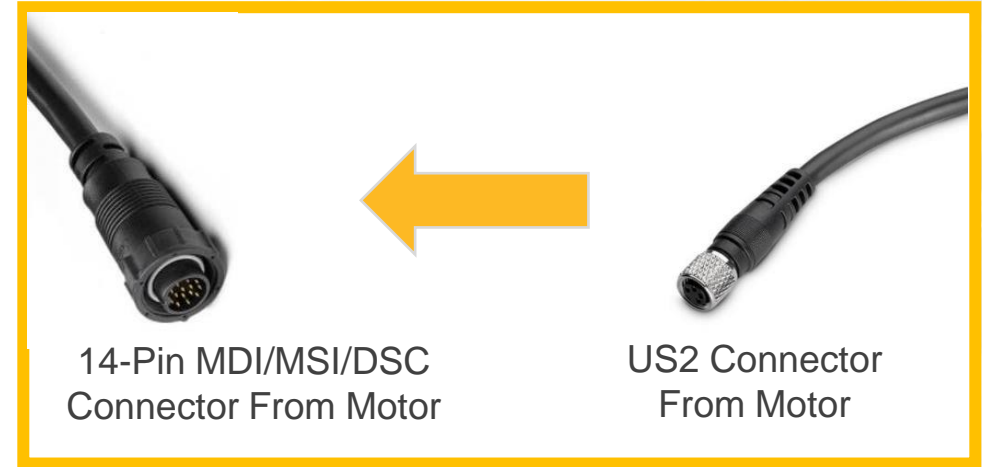

MINN KOTA/ HUMMINGBIRD ADAPTERS

Item	Compatibility
MKR-MI-1	MSI+, MDI+, DSC – HELIX 8-15 Models
MKR-MDI-2	MDI, DSC – HELIX 7 G2 / G3N Models

COMPETITIVE ADAPTERS

Description	DSC Item	US2 Item (reference)
LOWRANCE 7-PIN	MKR-DSC-10	MKR-US2-10
LOWRANCE 8-PIN (Triple Shot)	MKR-DSC-15	MKR-US2-15
LOWRANCE 9-PIN (Total Scan)	MKR-DSC-16	MKR-US2-16
GARMIN 4-PIN (Echo)	MKR-DSC-12	MKR-US2-12
GARMIN 8-PIN	MKR-DSC-14	MKR-US2-14

TROLLING MOTOR UPDATES

BUILT-IN DUAL SPECTRUM CHIRP

WHAT IS DUAL SPECTRUM CHIRP

What is CHIRP?

“Compressed High Intensity Radar Pulse”

How is it different:

Unlike traditional 2D sonar CHIRP scans a wide range of frequencies that will detect more well-defined fish.

More Pulses Mean More Detail:

CHIRP sonar fires off more sonar pulses than traditional 2D sonar. More pulses mean more detail and more clarity.

WHAT BENEFITS DOES IT BRING?

Target Separation:

Fish will appear more defined on the Humminbird unit due to the advanced target separation capabilities separating the fish return from the background habitat.

Clearly Defined Fish Arches:

Big arches are not always what you are looking for. Large game fish will show up as long, well-defined arches for quick identification and accurate lure presentation.

Strong Returns Without Noise:

Stop seeing things that aren't there. A high signal-to-noise ration translates to better-defined targets, less clutter, and greater certainty that what you are looking at on-screen is legit.



TROLLING MOTOR UPDATES

SIMPLIFYING WIRELESS REMOTES

CURRENT REMOTE OFFERING



COPiLOT



MICRO



I-PILOT



I-PILOT LINK



REMOTE CRADLE
1866675



MICRO
1866561



WIRELESS REMOTE
1866655

- Wireless Remote**
- (4) Programable OBN Buttons
 - Light Weight
 - Simplified Keypad
 - Intuitive UI Design
 - Recessed Power Key
 - Non-Slip Grip
 - 2.1" MIP LCD Display (not touch screen)
 - Dims: 5.4" x 2.0" x 1.3"
 - (2) AA Batteries

TROLLING MOTOR UPDATES

SIMPLIFYING WIRELESS REMOTES

CURRENT MOBILE APP OFFERING

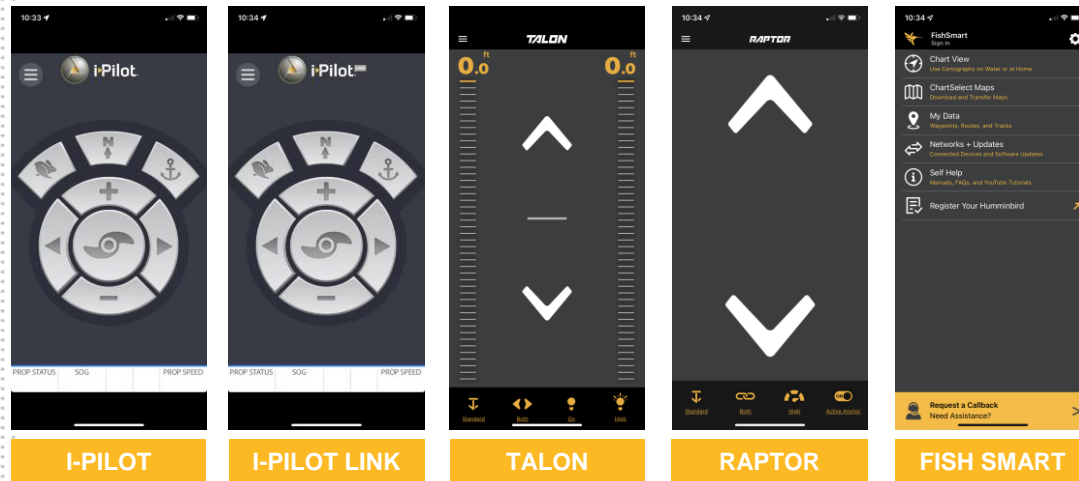

FY24 APP OFFERING

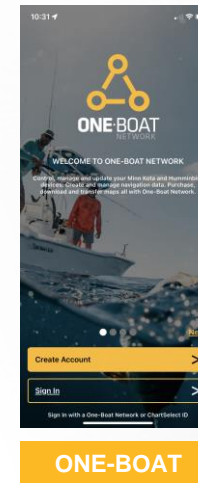

- Current App: Limited functionality and individual by product
- Consumers do not want to download multiple apps
- Difficult to maintain multiple apps

- All existing apps to be phased out completely
- Replaced by a single One-Boat Network app
- Full Humminbird and FishSmart features
- Full trolling motor controls and settings

TROLLING MOTOR UPDATES

QUEST BATTERY MONITORING

BATTERY MONITORING DETAILS

QUEST Battery Monitoring System

- Will only monitor trolling motor batteries
- Will display remaining battery life in 1% increments
(currently remote measures in 20%)
- Will display remaining battery life and run-time to empty
- Battery life can be measured while the prop is on
(currently prop has to be off)
- At 20% charge, a prompt will display to change to ECO mode
- Interface available on Humminbird unit only at this time

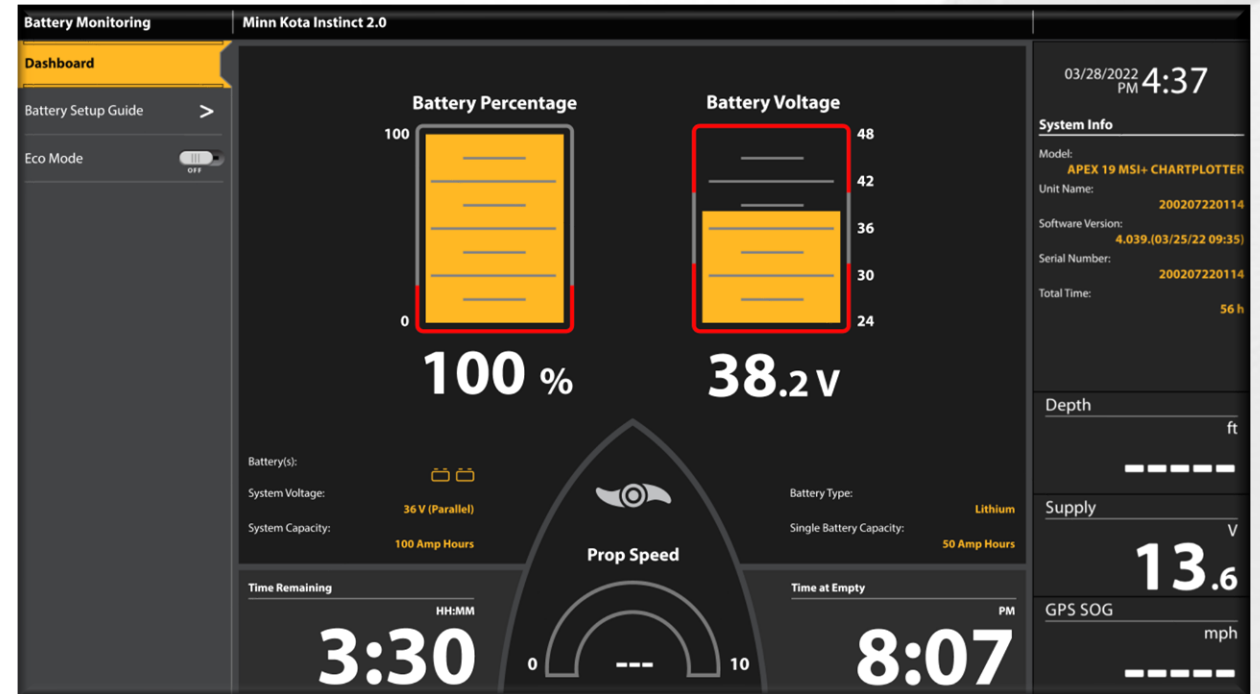

TROLLING MOTOR UPDATES

NEW FOOT PEDALS



ALL **QUEST SERIES** MOTOR FOOT PEDALS INCLUDE
PROGRAMMABLE **ONE-BOAT NETWORK BUTTON**

FY24 LINE UP

ELECTRIC STEER/ MULTI-SPECIES ANGLER

FRESHWATER

NEW

ULTERRA



ULTERRA

ULTERRA QUEST

TERROVA



TERROVA

TERROVA QUEST

POWERDRIVE



SALTWATER

NEW

RIPTIDE INSTINCT

INSTINCT
(ULTERRA)



INSTINCT BLACK
(ULTERRA)



RIPTIDE TERROVA

TERROVA



TERROVA QUEST



TERROVA QUEST
BLACK



RIPTIDE POWERDRIVE



FY24 LINE UP

CABLE STEER/ BASS ANGLER

FRESHWATER

ULTREX

NEW



FORTREX/ MAXXUM

NEW



EDGE



2024 PRODUCT LINE UPDATES

ULTREX

- 1. i-Pilot & i-Pilot Link:** i-Pilot and i-Pilot Link models are being obsoleted, and all Ultrex motors will be GPS-enabled models that are fully compatible with Humminbird fish finder units. – *Simplifies product line and allows for motors to take advantage of Humminbird integration right out of the box.*
- 2. Adapters:** All adapters and cables needed to connect GPS-enabled models to Humminbird fish finders will be included in the box. – *Simplifies the consumer buying and rigging experience.*
- 3. Built-in 2D Sonar:** Universal Sonar 2 models are being obsoleted and replaced by models equipped with Dual Spectrum CHIRP. – *Provides better clarity to the built-in 2D sonar offering.*
- 4. Upgraded Wireless Remote:** GPS-enabled models will include a wireless micro remote – Improving the consumer experience with a smaller and lighter remote when needed.
- 5. Quest Models Only:** New models specifically designed for the harshest environments and fishing conditions.
 - Most powerful Minn Kota ever developed - thrust, torque, prop design, mount
 - Brushless motor technology – more power, quieter operation, more run-time, dual 24V/36V
 - Integrated heading sensor – no longer need to mount an external heading sensor and simplifies rigging experience
 - Motor shafts infused with Carbon Fiber - additional strength that still allows for flexibility
 - Built-In MEGA Side Imaging – Only available on Quest models
 - Props: Both the weedless and high-efficiency props will be included in the box



2024 PRODUCT LINE UPDATES

ULTERRA & ULTERRA QUEST

- 1. i-Pilot & i-Pilot Link:** i-Pilot and i-Pilot Link models are being obsoleted, and all Ulterra motors will be GPS-enabled models that are fully compatible with Humminbird fish finder units. – *Simplifies product line and allows for motors to take advantage of Humminbird integration right out of the box.*
- 2. Adapters:** All adapters and cables needed to connect GPS-enabled models to Humminbird fish finders will be included in the box. – *Simplifies the consumer buying and rigging experience.*
- 3. Built-in 2D Sonar:** Universal Sonar 2 models are being obsoleted and replaced by models equipped with **Dual Spectrum CHIRP**. – *Provides better clarity to the built-in 2D sonar offering.*
- 4. Upgraded Wireless Remote:** GPS-enabled models will include a newly redesigned wireless remote – Improving the consumer experience with a smaller and lighter remote with more functionality.
- 5. Riptide Ulterra:** Riptide (saltwater) versions of Ulterra are being obsoleted
- 6. Quest Models Only:** New models specifically designed for the harshest environments and fishing conditions.
 - Most powerful Minn Kota ever developed - thrust, torque, prop design, mount
 - Brushless motor technology – more power, quieter operation, more run-time, dual 24V/36V
 - Integrated heading sensor – no longer need to mount an external heading sensor and simplifies rigging experience
 - Motor shafts infused with Carbon Fiber - additional strength that still allows for flexibility
 - Built-In MEGA Side Imaging – Only available on Quest models
 - Stabilizer: **72" shaft models will include a motor stabilizer kit included in the box**



2024 PRODUCT LINE UPDATES

TERROVA

- 1. i-Pilot & i-Pilot Link:** i-Pilot and i-Pilot Link models are being obsoleted and replaced by GPS-enabled models that are fully compatible with Humminbird fish finder units. – *Simplifies product line and allows for most Terrova motors to take advantage of Humminbird integration right out of the box.*
- 2. Adapters:** All adapters and cables needed to connect GPS-enabled models to Humminbird fish finders will be included in the box. – *Simplifies the consumer buying and rigging experience.*
- 3. Built-in 2D Sonar:** Universal Sonar 2 models are being obsoleted and replaced by models equipped with Dual Spectrum CHIRP. – *Provides better clarity to the built-in 2D sonar offering.*
- 4. Upgraded Wireless Remote:** GPS-enabled models will include a newly redesigned wireless remote – Improving the consumer experience with a smaller and lighter remote with more functionality.
- 5. Quest Models Only:** New models specifically designed for the harshest environments and fishing conditions.
 - Most powerful Minn Kota ever developed - thrust, torque, prop design, mount
 - Brushless motor technology – more power, quieter operation, more run-time, dual 24V/36V
 - Integrated heading sensor – no longer need to mount an external heading sensor and simplifies rigging experience
 - Motor shafts infused with Carbon Fiber - additional strength that still allows for flexibility
 - Built-In MEGA Side Imaging – Only available on Quest models
 - Longer Shafts – Addition of 100” shaft models in the Riptide Terrova Quest family



2024 PRODUCT LINE UPDATES

POWERDRIVE AND RT POWERDRIVE

- 1. i-Pilot:** i-Pilot models are being obsoleted and replaced by GPS-enabled models that **are fully compatible with Humminbird fish finder units.** – *Simplifies product line and allows for PowerDrive motors to take advantage of Humminbird integration.*
- 2. Adapters:** All adapters and cables needed to connect GPS-enabled models to Humminbird fish finders will be included in the box. – *Simplifies the consumer buying and rigging experience.*
- 3. Built-in 2D Sonar:** Universal Sonar 2 models are being obsoleted and replaced by models equipped with Dual Spectrum CHIRP (DSC). – *Provides better clarity to the built-in 2D sonar offering.*



2024 PRODUCT LINE UPDATES

RIPTIDE TERROVA & TERROVA QUEST

- 1. i-Pilot & i-Pilot Link:** i-Pilot and i-Pilot Link models are being obsoleted and replaced by GPS-enabled models that are fully compatible with Humminbird fish finder units. – *Simplifies product line and allows for most Terrova motors to take advantage of Humminbird integration right out of the box.*
- 2. Adapters:** All adapters and cables needed to connect GPS-enabled models to Humminbird fish finders will be included in the box. – *Simplifies the consumer buying and rigging experience.*
- 3. Built-in 2D Sonar:** Universal Sonar 2 models are being obsoleted and replaced by models equipped with Dual Spectrum CHIRP. – *Provides better clarity to the built-in 2D sonar offering.*
- 4. Upgraded Wireless Remote:** GPS-enabled models will include a newly redesigned wireless remote – Improving the consumer experience with a smaller and lighter remote with more functionality.
- 5. Quest Models Only:** New models specifically designed for the harshest environments and fishing conditions.
 - Most powerful Minn Kota ever developed - thrust, torque, prop design, mount
 - Brushless motor technology – more power, quieter operation, more run-time, dual 24V/36V
 - Integrated heading sensor – no longer need to mount an external heading sensor and simplifies rigging experience
 - Motor shafts infused with Carbon Fiber - additional strength that still allows for flexibility
 - Built-In MEGA Side Imaging – Only available on Quest models
 - Longer Shafts – Addition of 100" shaft models in the Riptide Terrova Quest family



2024 PRODUCT LINE UPDATES

RIPTIDE INSTINCT

1. **Riptide Instinct:** New family of auto stow/deploy motors specifically designed for harsh saltwater environments
2. Most powerful Minn Kota ever developed - thrust, torque, prop design, mount
3. Brushless motor technology – more power, quieter operation, more run-time, dual 24V/36V
4. Integrated heading sensor – no longer need to mount an external heading sensor
5. Motor shafts infused with Carbon Fiber - additional strength that still allows for flexibility
6. Upgraded Wireless Remote – GPS-enabled models will include a newly redesigned wireless remote that is smaller, lighter, and more functionality
7. Props: Ships with a high-efficiency prop included in the box
8. Stabilizer: 72" and longer shaft models will include a motor stabilizer kit included in the box
9. **GPS-Enabled:** All Riptide Instinct models come standard with advanced navigation features and are fully compatible with Humminbird fish finder units.
10. **Adapters:** All adapters and cables needed to connect with Humminbird fish finders will be included in the box.



AUTO STOW/DEPLOY DESIGN UPDATES

RIPTIDE INSTINCT

1. **Trim Module Slip Ring:** Replaced slip rings and wireless communication with a wired connection for better reliability
2. **Wireless Communication - Control Board and Trim Module:** Replaced with wired connection/communication
3. **Trim Housing Sealing:** Modular compartments for gear motor sealed separately from the belt and pulley using aluminum castings to ensure no saltwater comes into contact with the gear motor.
4. **Tilt Actuator:** Moved to center for even loading; wired connection to help with tilt during full extend
5. **Stow Sensor:** Redesigned mechanism with a more durable spring (torsion)
6. **Steering/Trim Resolution:** Added true position sensors for trim and steering even in the event of lost power
7. **Motor Control Board:** Now field updateable with software updates
8. **Control Box:** Sealing design improvements to keep water out
9. **Emergency Stow Process:** New simplified E-stow design in the event of power loss
10. **Error Detection and Reporting:** Improved error detection and reporting

AUTO STOW/DEPLOY DESIGN UPDATES

RIPTIDE INSTINCT

Trim Module Communication

- To mitigate the risk of saltwater corrosion happening, a sealed and reliable direct wired connection between the control board, trim motor, and position sensor

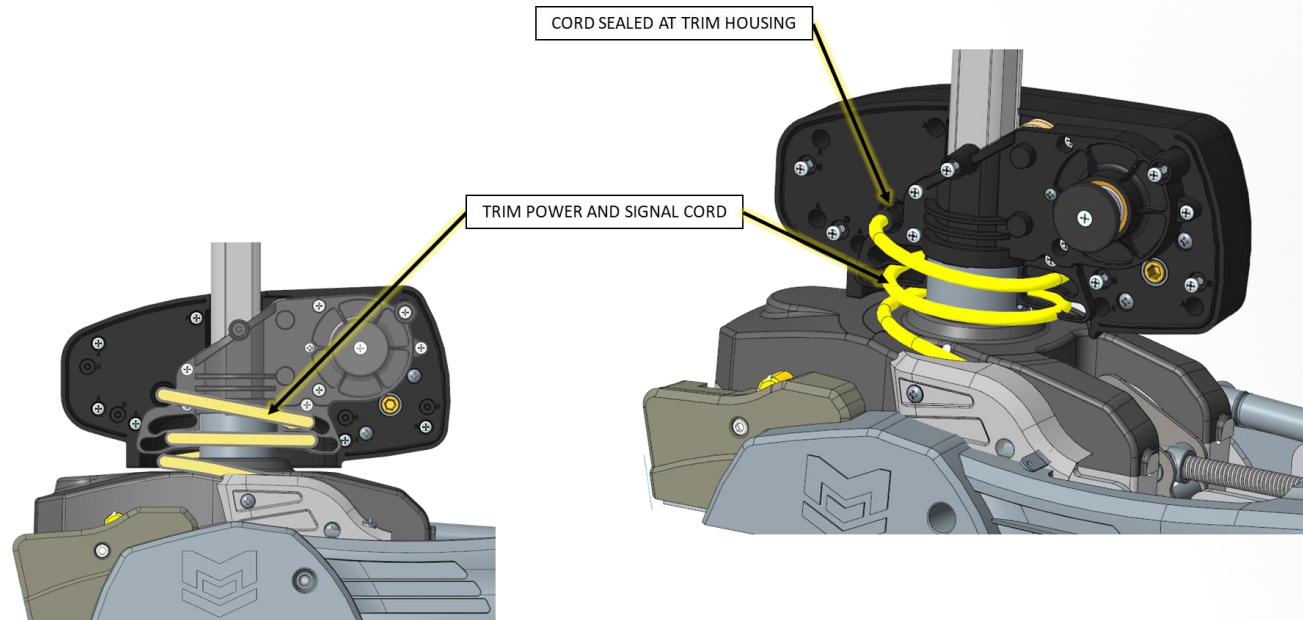

AUTO STOW/DEPLOY DESIGN UPDATES

RIPTIDE INSTINCT

Trim Housing Sealing

- Motor and sensor are encased separately in a sealed housing away from saltwater exposure
- Sealing with machined cast aluminum housings
- Hard connection between trim housing and steering output tube bushing for rotation and radial loads
- Trim position sensor does not lose position with power off, loss of power, or manual trim release
- Manual trim release mechanism allows the stowing of the motor without power or the need for tools

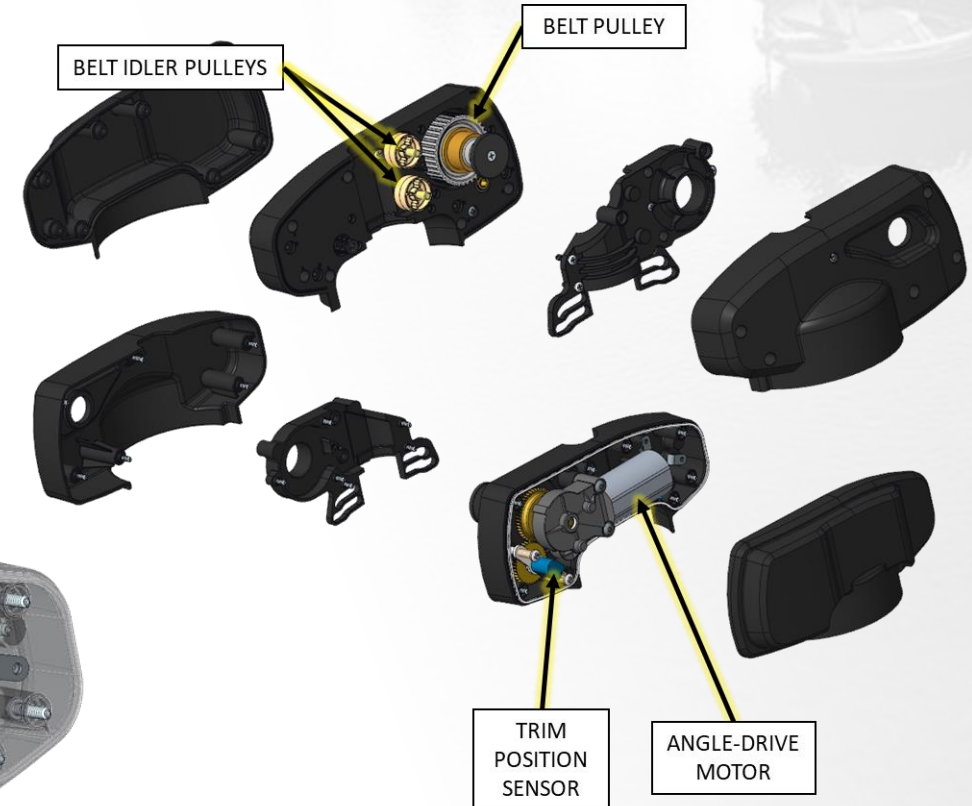
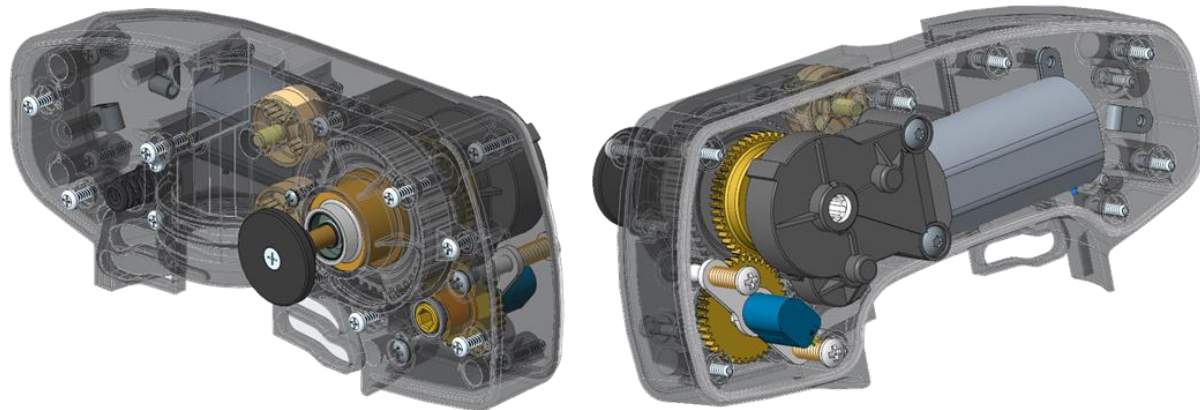

TROLLING MOTOR UPDATES

TROLLING MOTOR ACCESSORIES



CIRCUIT BREAKER 60A

MKR-27 ~ 1865115



TM PLUG & RECEPTACLE

MKR-28 ~ 1865120

ACCOMMODATIONS FOR
HEAVIER (UP TO 1 AWG)
WIRE RIGGING AS
BRUSHLESS MAY
REQUIRE

TROLLING MOTOR UPDATES

MOTOR ACCESSORIES



MKA-57 ~ 1854057



MKA-58 ~ 1854058



RTA-55 ~ 1854055

Item Number	Description	Ultrex	Ultrex Quest	Terrova	Terrova Quest	Riptide Terrova	Riptide Terrova Quest	Ulterra	Ulterra Quest	Instinct Quest	Notes
1854062	RTA-62 Composite QRB			X		X		X			Replaces 1854054
1854063	RTA-62 Composite QRB (Bulk)			X		X		X			Replaces 1854052
1754064	MKA-64 Composite QRB			X		X		X			Replaces 1854053
1754055	RTA-55 Heavy Duty Composite QRB				X		X		X	X	
1854056	MKA-56 Heavy Duty Composite QRB				X		X		X	X	
1854057	MKA-57 Aluminum Slide QRB				X		X		X	X	
1862042	MKA-61 Cable-Steer QRB (Short)	X	X								Replaces 1862014
1862052	MKA-62 Cable-Steer QRB (Long)	X	X								Replaces 1862016
1854058	MKA-58 Deck Reinforcement Plate				X		X		X	X	

TROLLING MOTOR UPDATES

FEATURE LIST OVERVIEW

QUEST SERIES MOTORS ONLY

- Heavy-duty platform construction from the ground up
- 24/36V dual voltage compatibility in a single motor
- Greater thrust and torque (*compared to MK brushed motors*)
- Quieter (*compared to MK brushed motors*)
- Longer shafts up to 100" (*reinforced with carbon fiber*)
- Ability to update QUEST Motor Controller software
- Physical One-Boat Network Button on the foot pedal
- Prop Stow Orientation - "Auto Park" (*Prop Left/Prop Right*)
- Straight Ahead on Deploy (*On/Off*)
- Motor LED Brightness Control
- Built In Heading Sensor
- ECO Mode (*Reduces max power by 20% to reduce overall current draw to aid in extending battery life*)
- Trolling Motor Battery Monitoring (*HB units, app, and Remote*)
- Error Codes (*Provides diagnostic codes to aid consumers and service centers in troubleshooting*)

ALL NEW BOW MOUNT MOTORS

- Four Physical One-Boat Network Button on remote
- Follow the Contour - Follow Shoreline (VX Only)
- Follow the Contour/Shoreline at the Vessel with Cursor (VX Only)
- Follow the Contour/Shoreline at Vessel with single button (VX Only)
- Follow the Contour Dodge (VX Only)
- Follow the Contour Jog (VX Only)
- Dodge Mode (*while in a navigation mode, the user can temporarily suspend or pause the nav mode to manually steer and then resume the suspended navigation mode*)
- Locked Heading AutoPilot Adjust (*Angular or Parallel Jog*)
- Drift Mode & Drift Mode Reverse
- Locked Course AutoPilot Adjust (*Angular or Parallel Jog*)
- Locked Course and Locked Heading Autopilot Reverse
- Motor Direction Indicator on MK Remote, App, and HB